

Maba Fertigteilindustrie

enature® fishpass, research and
development, practical examples

20.02.2014

Romanian HydroPower, Energy Summit 2014

Dipl.-Ing. Michael Pötsch

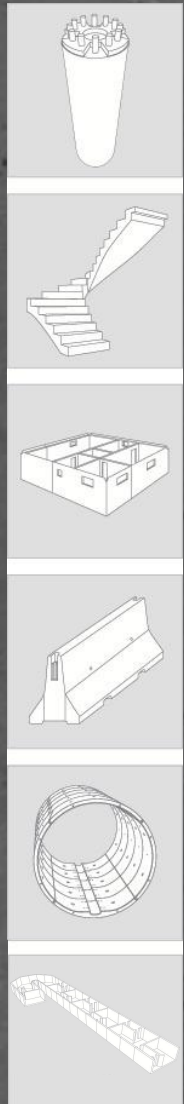

KAMA
BETONFERTIGTEILE

COMPETENT & RELIABLE

T +43 (0)57715 400-0, www.maba.at

MABA
FERTIGTEILINDUSTRIE
Member of the
KIRCHDORFER
GROUP
www.kirchdorfer.at

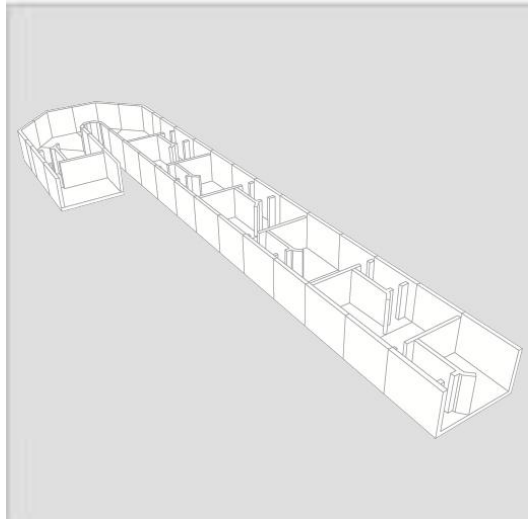
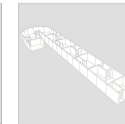
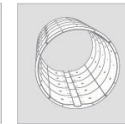
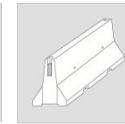
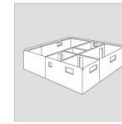
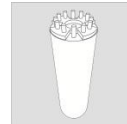

enature[®] FISHPASS

- types
- target, research & development
- result, tools for the operator
- projects

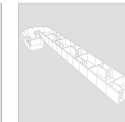
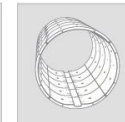
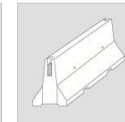
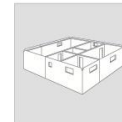
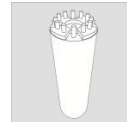

- bypass channel
- pool pass
- rock ramp
- vertical slot



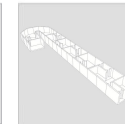
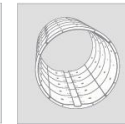
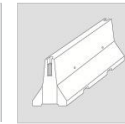
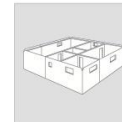

target



optimize fish migration
minimize water flow rate

result

standardized precast
concrete system
EU patent

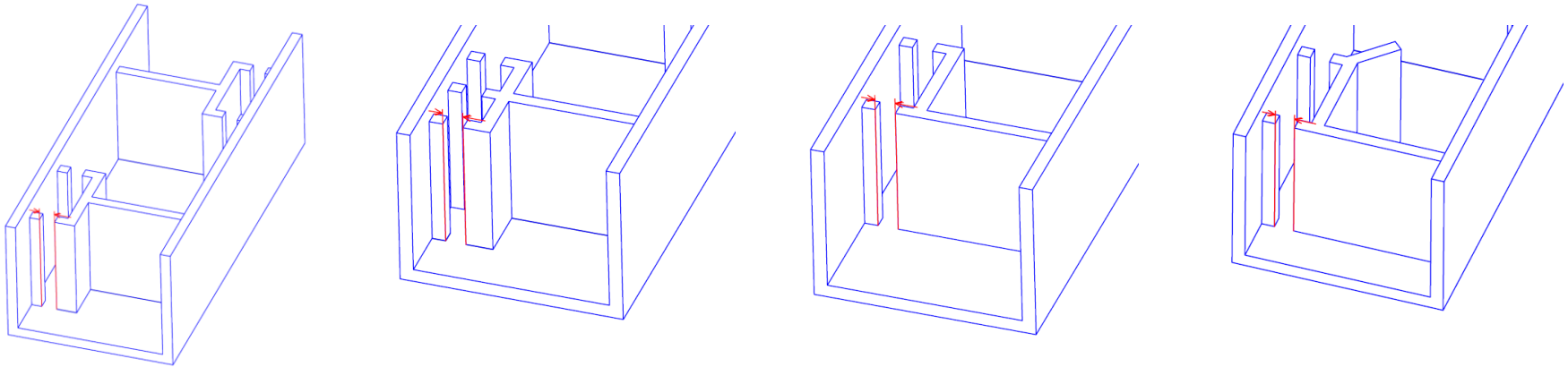
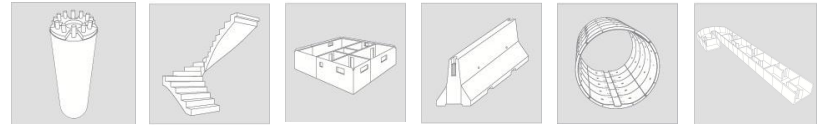

1:5 model

test new structures

physical model

- 3D velocity
- turbulences



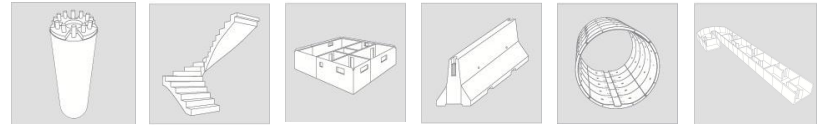

1:1 physical model

34 type

(pool length, width, slotwidth, angle ...)

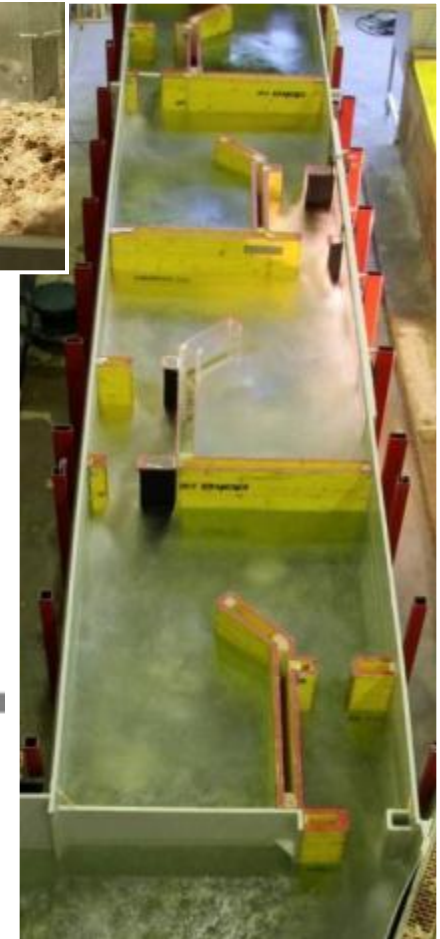

flow rate l/s

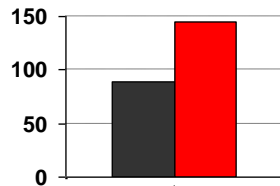

turbulent kinetic energy cm^2/s for all level

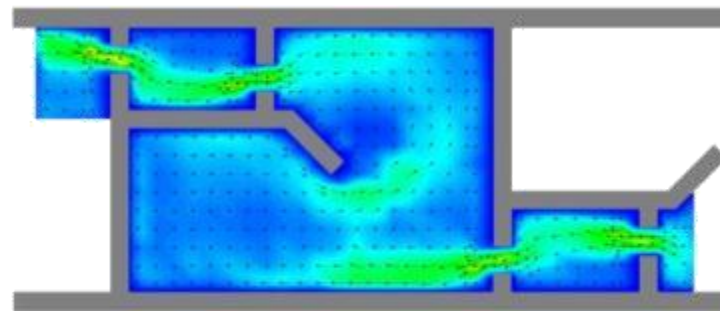
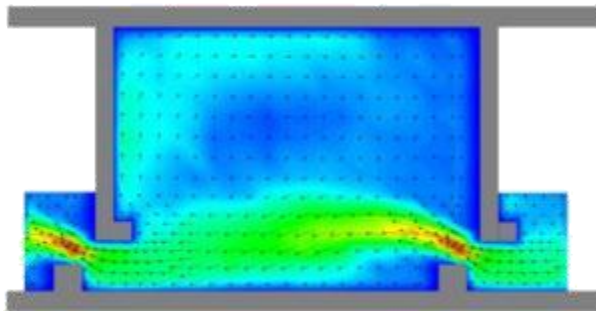
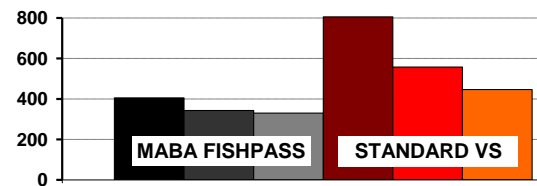

velocity cm/s
near ground level

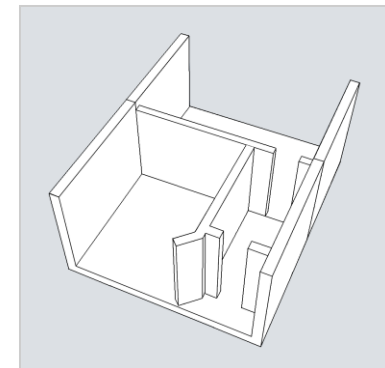
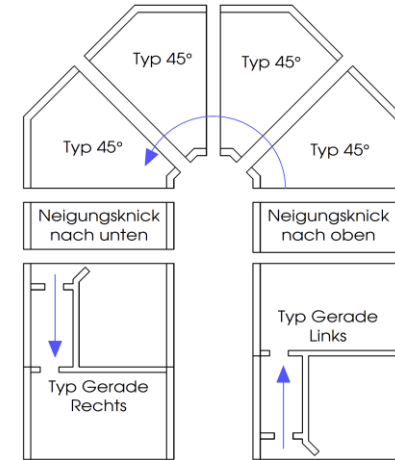
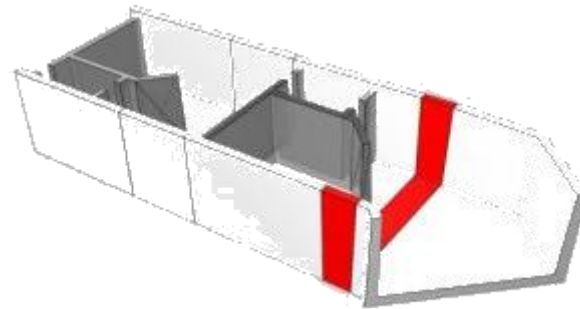
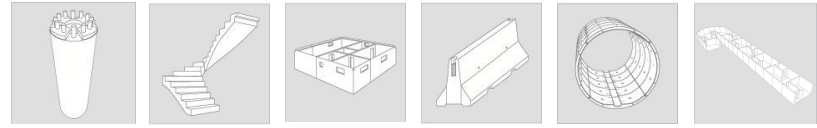

standardization

3 system sizing

pool length	200 / 300 / 400 cm
pool width	145 / 217 / 290 cm
slot	15 / 20 / 25 / 30 / 35 / 50 cm
delta H	10 / 13 / 15 / 17 / 18 / 20 cm

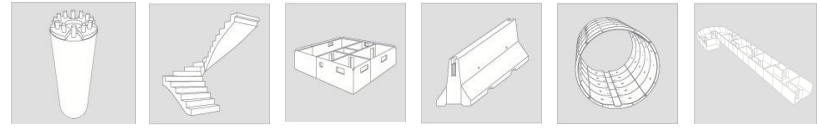

hydrauliktool

www.maba-fishpass.com

Standard Vertical Slot:
flow rate: **563 l/s**
dissipation: **113 W/m³**

enature FISHPASS:
flow rate: **349 l/s**
dissipation: **73 W/m³**

- ⇒ **38% reduced flow rate**
- ⇒ **36% reduced dissipation**
- ⇒ **20% reduced velocity**

ENTWURF EINES ENATURE FISHPASSES
SYSTEMTYPISCHES MITTEL

Systemgröße: Auswahlverfahren:	MITTEL Systemgröße Vorgabe min. Wasserstand	Vertical Slot dimensionsgleich	enature Fishpass	Unterschied
Durchfluss	563 l/s	349 l/s	-38 %	
Energieverlust	113 W/m ³	73 W/m ³	-36 %	
Max. Fließgeschwindigkeit	1,72 m/s	1,38 m/s	-20 %	
Schüttbreite	20 cm	20 cm	0 %	
Wasserhöhe-Differenz	15 cm	15 cm	0 %	
Min. Wasserhöhe	105 cm	105 cm	0 %	
Beckenbreite-Länge	217,5/300 cm	217,5/300 cm	0 %	

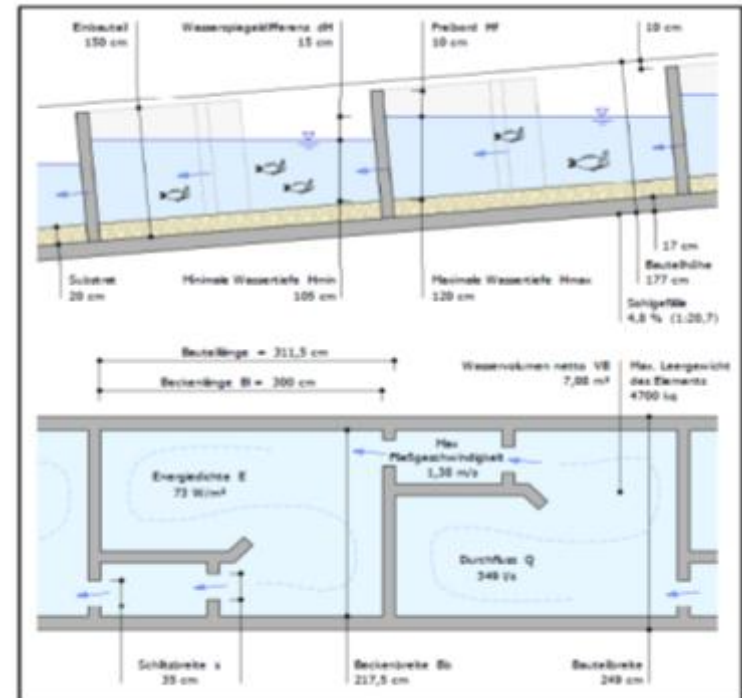

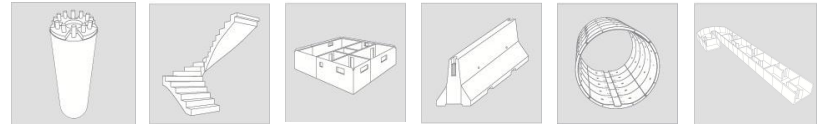

2D and 3D planningtool

download

www.maba-fishpass.com

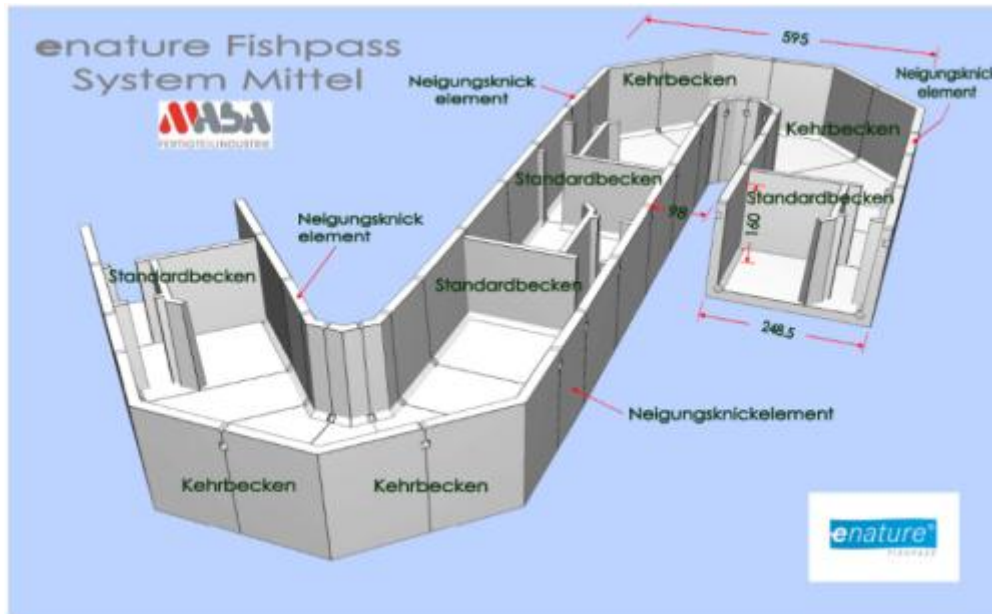

SYSTEM MITTEL
dH = 15 cm / Becken
s = 35 cm
2D

GRUNDRISS - SET
für Neigung dH = 15cm von Becken zu Becken
für Schlitzbreite s = 35cm

- Neigung des Ft. bereits auf eine Wasserspiegeldifferenz von 15cm pro Becken inkl. 0,5cm Fuge berücksichtigt!
- Im Grundriss an den Knotenpunkten (-) einfach aneinander fügen!
- Auf Neigungsknickelement vor und nach Kehrbecken nicht vergessen!
- Kehrbecken und Neigungsknickelemente werden stets auf horizontalem Untergrund versetzt!
- Die Standardbecken werden in der vorgesehenen Neigung versetzt!

NEIGUNGSKNICKELEMENT
von horizontal auf aufsteigend geneigt

GEW. 2425kg

NEIGUNGSKNICKELEMENT
von horizontal auf abfallend geneigt

GEW. 2150kg

45° KEHRBECKEN

GEW. 1500kg

STANDARDBECKEN
Schlitz orographisch links
bestehend aus 2 Fertigteilen

GEW. 4225kg

STANDARDBECKEN
Schlitz orographisch rechts
bestehend aus 2 Fertigteilen

GEW. 4275kg

Version: A		V6278007 / 2
04.11.2010 / RG		13.09.2010 / RG
MAUS: 1:75		

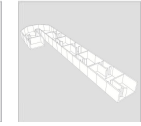
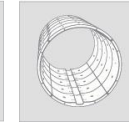
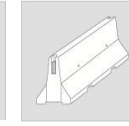
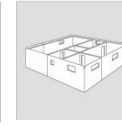
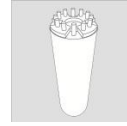

St. Katharein
river Laming
28 pools

Hart
river Ager
19 pools

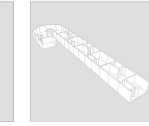
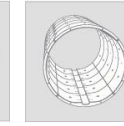
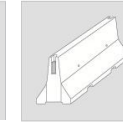
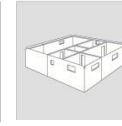
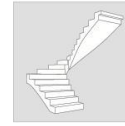
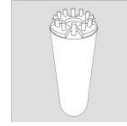

Bolzano, Italy
river Talfer
43 pools
4 resting pools



enature®
FISHPASS

MBA
FISCHEREI-GERÄTE

GLS
BESTE PREISE MIT BESTER SERVICE

S

218



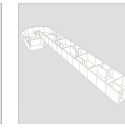
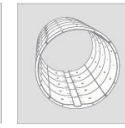
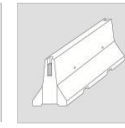
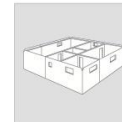
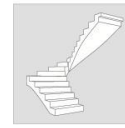
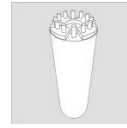

distributor for Romania:

**KAMAROM Prefabricate din Beton
S.R.L
Valentin Prefac**



Bucarest West-Logistik Park,
Dragomiresti Vale
M + 40 (0) 747 236 646
valentin.prefac@kama.co.at

dirk.dillmann@kama.co.at
michael.poetsch@maba.at